

Shaker Workbench

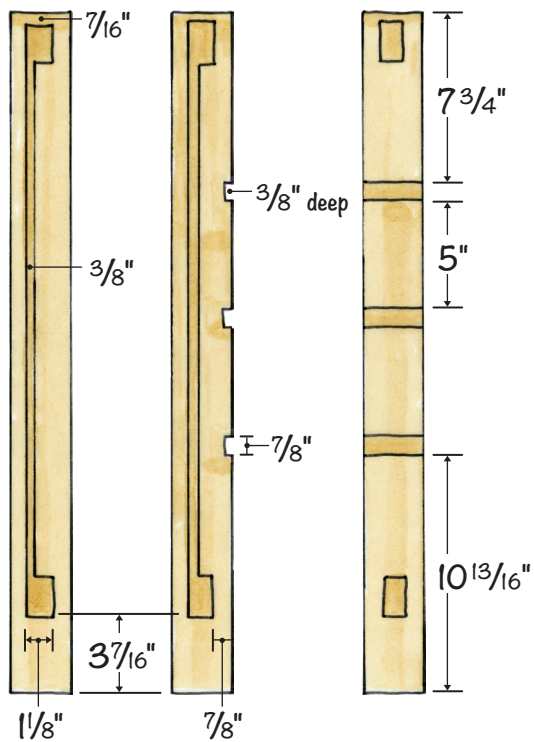

LEGS

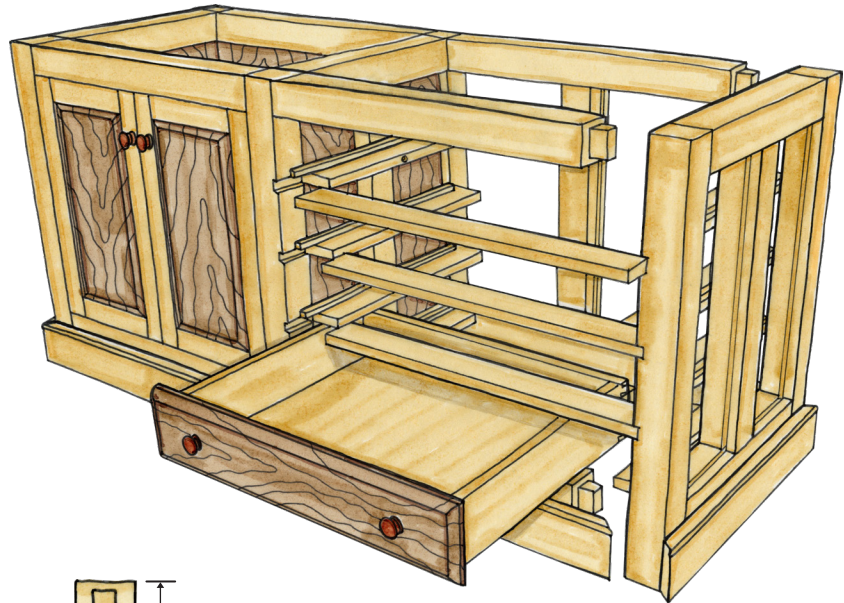

DOOR

NOTE: For further joinery details and a full SketchUp model, visit PopularWoodworking.com/OnlineExtras

Tenons for base parts are $1\frac{1}{4}" \times 1\frac{7}{8}"$ and 1" long (mitered where tenon corners meet). Mortises are sized to match.

The top shown here is a simple glue up, similar to the main photo. Add vises to suit your needs.

Panels fit into a groove that is $\frac{3}{8}" \times \frac{3}{8}"$

Doors are built over-sized and trimmed to fit the opening

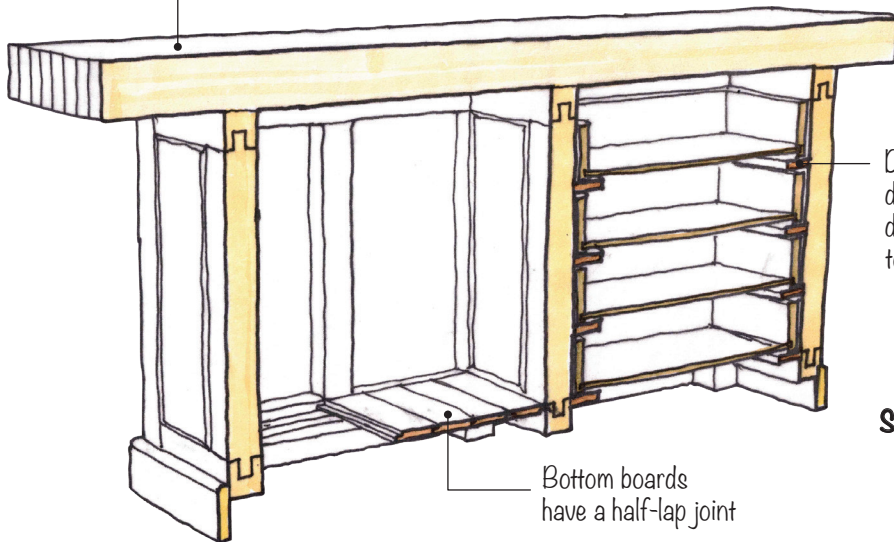

Drawer runners are dominoed into front divider, and screwed to side panels

FRONT SECTION VIEW

Bottom boards have a half-lap joint

Panels profiles are a 45° bevel with a $\frac{3}{8}" \times \frac{3}{8}"$ tongue.

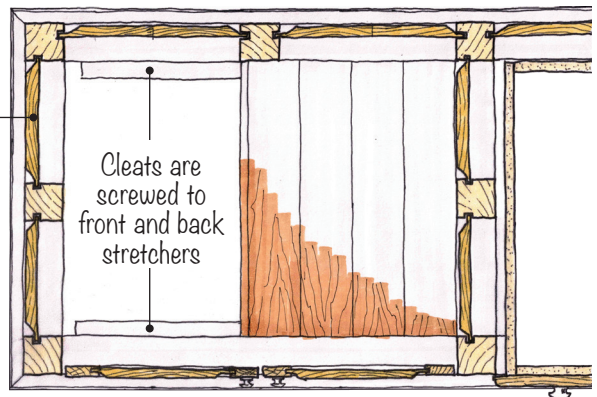

Cleats are screwed to front and back stretchers

TOP SECTION VIEW